

(W/O COVER)

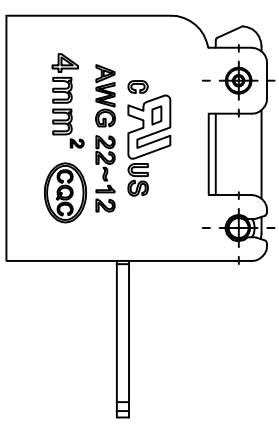
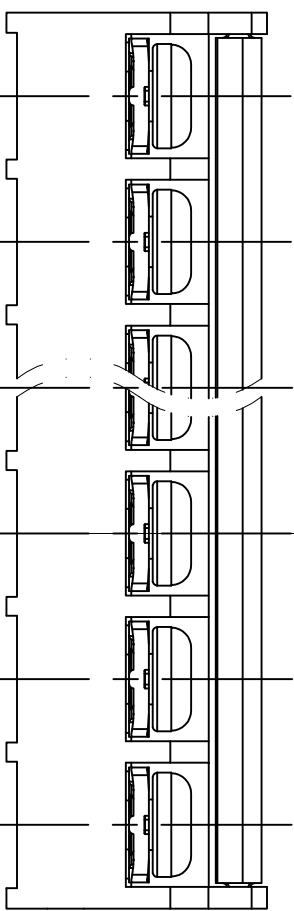
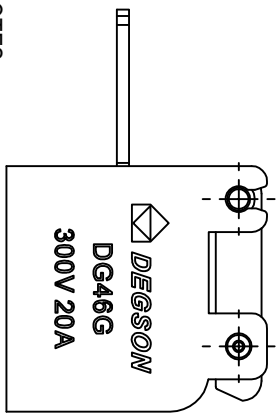
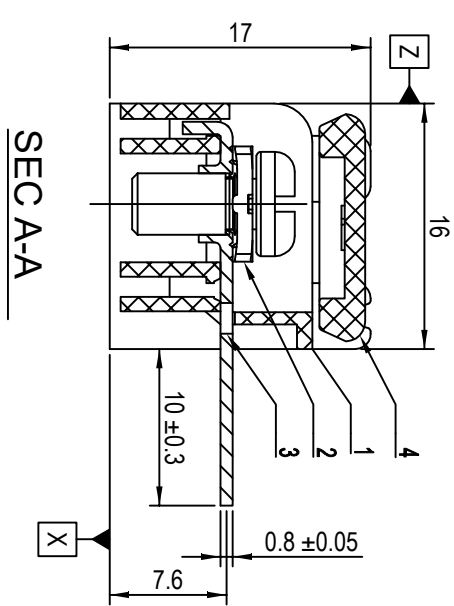

- NOTES:
1. DIMENSION SHALL BE INTERPRETED PER ASME Y14.5-2009;
 2. PITCH : 9.5mm, POLES : N=02 ~ 12P;
 3. UL : 300V/20A;
 4. IEC : 450V/32A;
 5. SLOWER LIMIT TEMPERATURE : -40 °C;
 6. UPPER LIMIT TEMPERATURE : +105 °C;
 7. WIRE RANGE : 4MM², 22AWG~12AWG;
 8. TORQUE VALUE : M4 1.2N.m/10.53Lb.in;
 9. UNDIMENSIONED TOLERANCES:

Note: The A&Z (H) in the name means .A.(H) and Z(H).

ITEM	NAME OF PART	MATERIAL	NOTES
4	Cover	PC	UL94V-2
3	Pin Header	Brass	Sn Plated
2	Screw	Steel	Ni Plated
1	Housing	PA66	UL94V-0



APPR: 核准人	核准日期	NAME
CMND: 审核人	审核日期	MAT NO./REV: / /
DWGT: 设计人	设计日期	MAT STATUS: / /
MA	(1/1)	

00	REV	ECN	DESCRIPTION	DWGT	DATE	DRAWING NO.	TYPE	DRAWING STATUS	SCALE	SHEET
1	2	3	4	5	6	200073293	DC46GR-B-XXP-1Y-00A&Z(H) CUSTOMER DRAWING	/	2:1	1/1